

1.0弯插式FPC

SPECIFICATIONS

Insulator resistance:
 ≥ 500 Megohms Min.
 Dielectric withstanding:
 AC/DC 50V
 Operating temperature:
 $-25^{\circ}\text{C} - +85^{\circ}\text{C}$
 Contact Material:
 Phosphor Bronze
 Insulator Material:
 Nylon-46(白色) UL94V-0
 Finish:
 Tin Plated

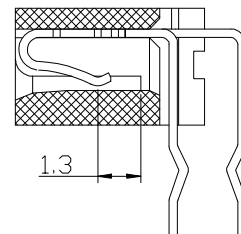
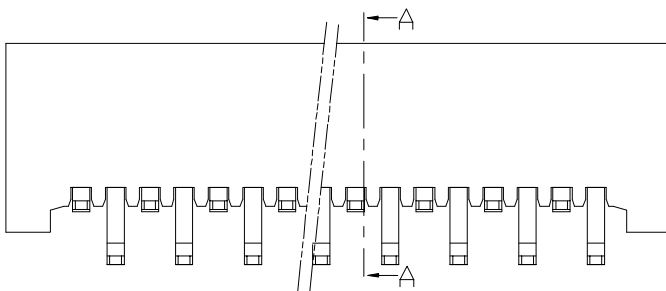
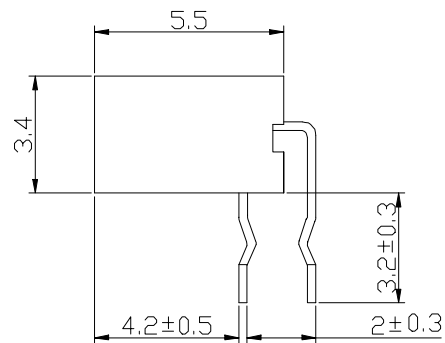
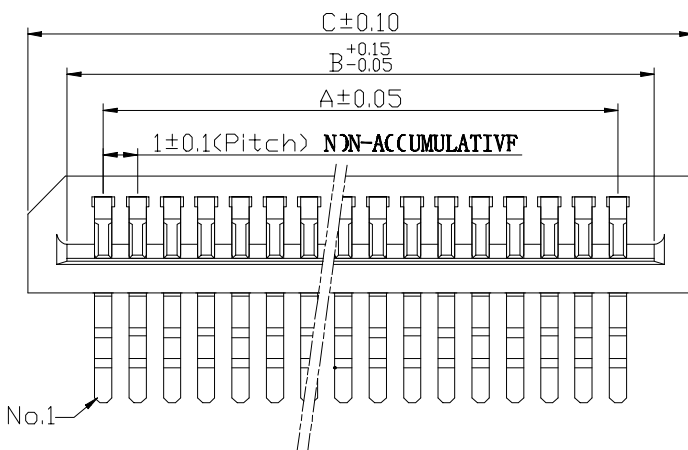
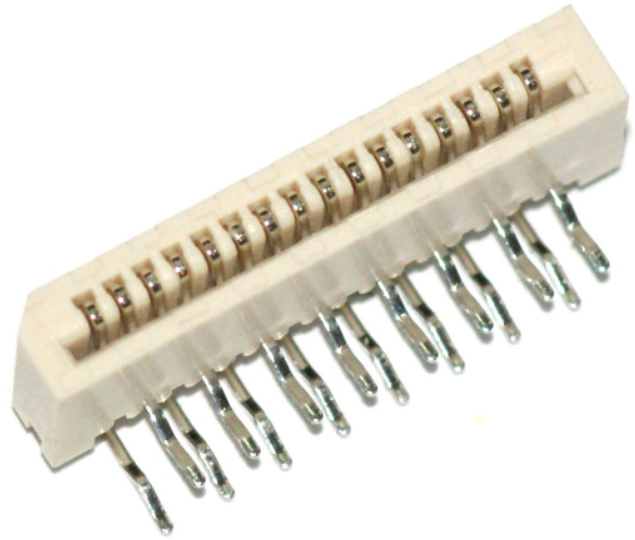

E 1 0 1 0 - X X X 1 0 W - 0 1 T SEC:A-A

Insulator material
 E: Nylon-46
 L: LCP

Number of Contact

Appearance of pin header
 J10: 上接触
 J20: 下接触
 D10: 弯插式

Color

Plating material
 G Gold Plated
 T Tin Plated
 H Duplex Plated

Plating thickness
 01 Normal
 08 8u"
 15 15u"