

# 2.54 Series

## Female Header / Dual Row Entry

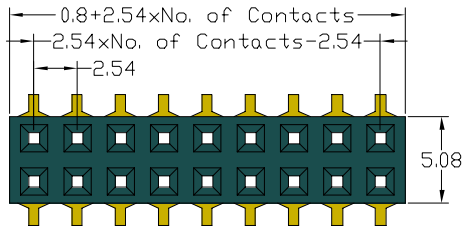

### Recommended P.C.Board Hole Layout

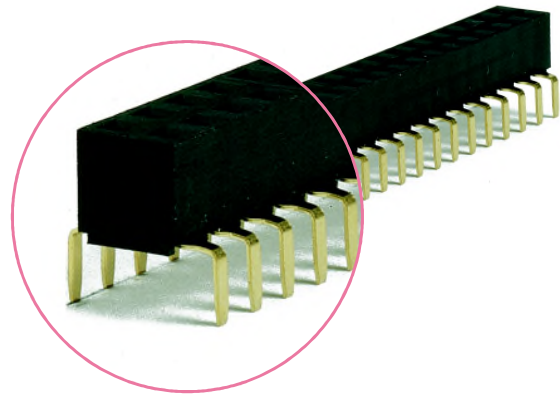
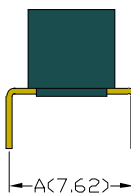
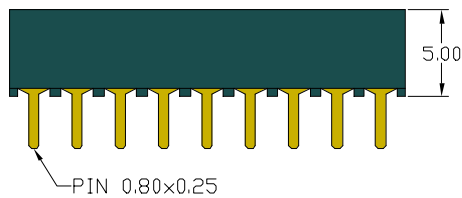
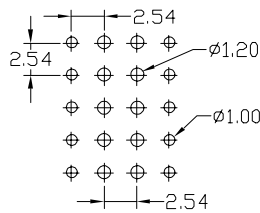

### SPECIFICATIONS

- Current Rating: 3 Amps
- Insulator resistance: 5000 Megohms Min.
- Contact resistance: 20 m ohm Max.
- Dielectric withstanding: AC 500 V
- Operating Temperature:  $-40^{\circ}$  -  $+105^{\circ}$ C
- Contact Material: Phosphor Bronze
- Insulator Material: Standard: P.B.T
- Finish: Gold flash or Tin plated or Duplex plating

P 8 5 5 2 - x x C 1 0 - x x x

Row of pin  
2 = dual row

Number of contacts  
04~80

Dual entry

Plating thickness	
01	Normal
03	3 $\mu$
05	5 $\mu$
10	10 $\mu$
15	15 $\mu$
30	30 $\mu$

Plating material	
G	Gold plated
T	Tin plated
P	Lead & Tin plated
H	Selective gold plated